

## SPECIFICATIONS

# NATIVESTONE® VANITY TOP FOR FLOATING VANITY

VESSEL CUTOUT - NO FAUCET HOLES

*NativeStone® Collection*

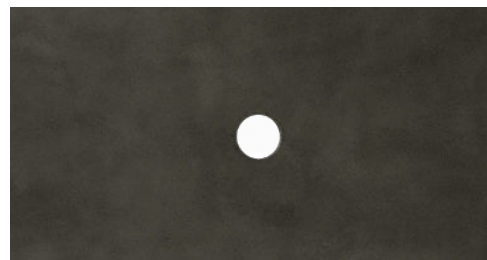

TOP VIEW

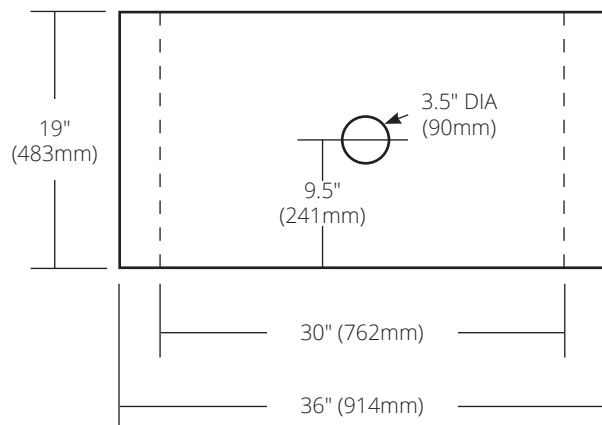

### 30" Vanity Top

30"w x 19"d x 1.18"h (762mm x 483mm x 30mm)

VTF30-V-A-0 Ash  
VTF30-V-C-0 Charcoal  
VTF30-V-D-0 Sand  
VTF30-V-E-0 Earth  
VTF30-V-P-0 Pearl  
VTF30-V-S-0 Slate

### 36" Vanity Top

36"w x 19"d x 1.18"h (914mm x 483mm x 30mm)

VTF36-V-A-0 Ash  
VTF36-V-C-0 Charcoal  
VTF36-V-D-0 Sand  
VTF36-V-E-0 Earth  
VTF36-V-P-0 Pearl  
VTF36-V-S-0 Slate

## PRODUCT DETAILS

- No Faucet Hole
- Handcrafted from sustainable NativeStone
- Sealed with NativeStone Shield™

## COORDINATING PRODUCTS

- Topanga, Vintner's or Winemaker Floating Vanities
- Pairs with most vessel sinks
- Drains: DR120, DR130 or DR150

### IMPORTANT

DO NOT use tape or other adhesives on NativeStone as it may remove the sealer.

Due to the handcrafted nature of this product, it will vary in finish, texture, and other details. Dimensions may vary up to ¼" (6mm).

To identify Made to Order versus stocked vanity tops, please visit [nativetrailshome.com/vanitytops](http://nativetrailshome.com/vanitytops) or the Dealer Portal.