

*SPECIFICATIONS*

# 36" PALOMAR VANITY TOP WITH INTEGRAL SINK

NativeStone® Collection

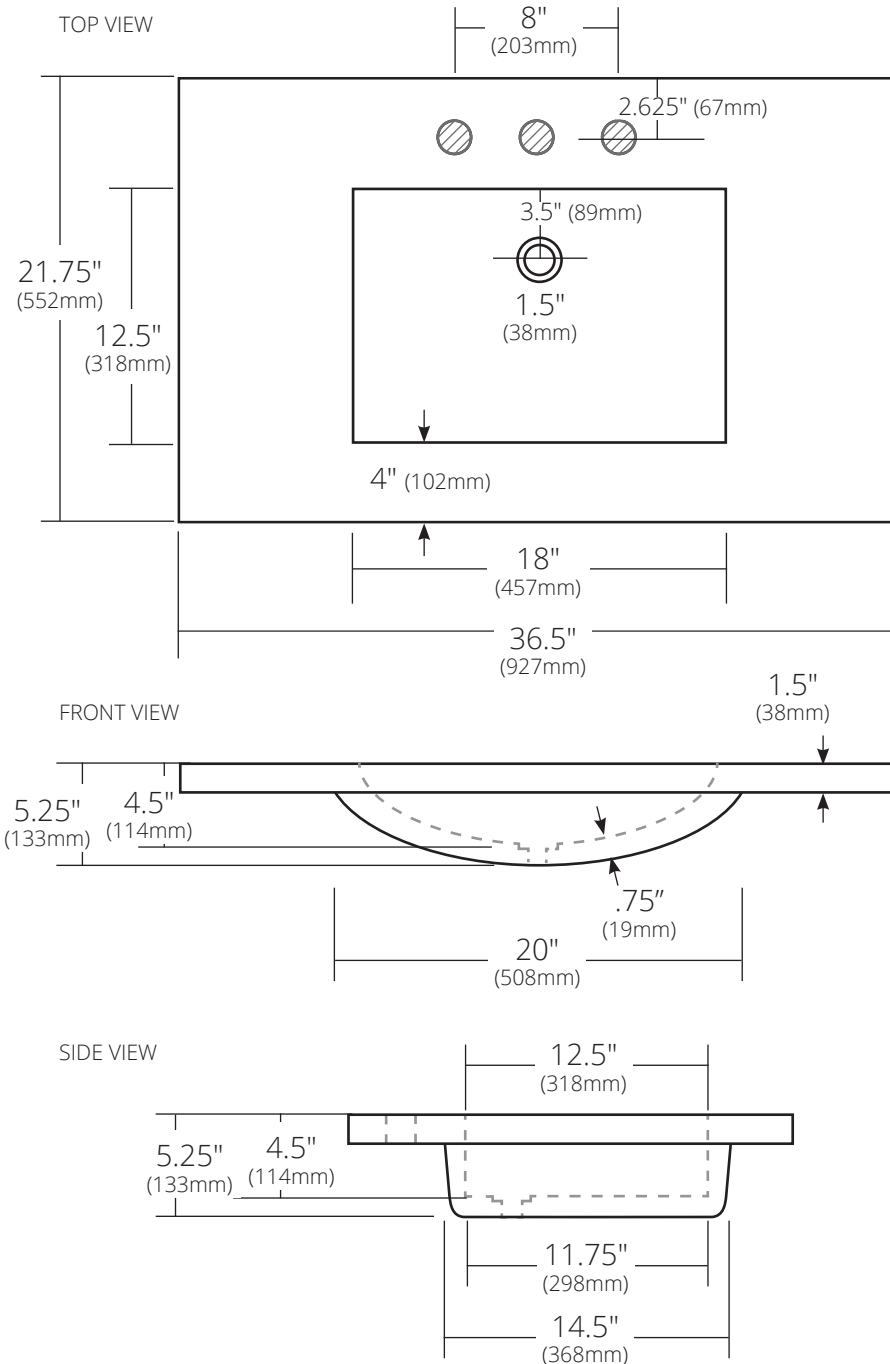
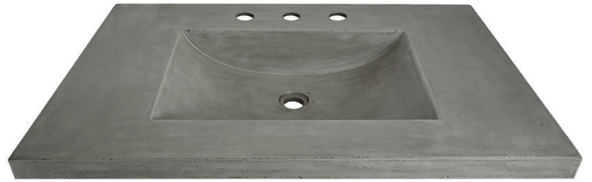

- |  |  |
|--|--|
| <ul style="list-style-type: none"> <li>8" Faucet Spread</li> <li>NSVNT36-A Ash</li> <li>NSVNT36-S Slate</li> <li>NSVNT36-P Pearl</li> <li>NSVNT36-E Earth</li> </ul> | <ul style="list-style-type: none"> <li>Single Faucet Hole</li> <li>NSVNT36-A1 Ash</li> <li>NSVNT36-S1 Slate</li> <li>NSVNT36-P1 Pearl</li> <li>NSVNT36-E1 Earth</li> </ul> |
|--|--|

**PRODUCT DETAILS**

- 36.5" x 21.75" x 5.25" OD (927mm x 552mm x 133mm)
- Basin 18" x 12.5" x 4.5" (457mm x 318mm x 114mm)
- 1.5" (38mm) drain opening
- Pre-drilled for 8" (203mm) faucet spread or single faucet hole
- Handcrafted from sustainable NativeStone®
- Sealed with impermeable nano sealer

**COORDINATING PRODUCTS**

- Drains: DR120, DR130 or DR150
- NativeStone® Sealer

**STANDARDS COMPLIANCE**

- UPC/cUPC compliant
- **ADA COMPLIANT**

**IMPORTANT**

Do NOT use tape or other adhesives on NativeStone® as it may remove the sealer.

Due to the handcrafted nature of this product, it will vary in finish, texture, and other details. Dimensions may vary up to 1/4" (6mm).