

SPECIFICATIONS

CUZCO LINEN TOWER

Cuzco Collection

FRONT VIEW

SIDE VIEW

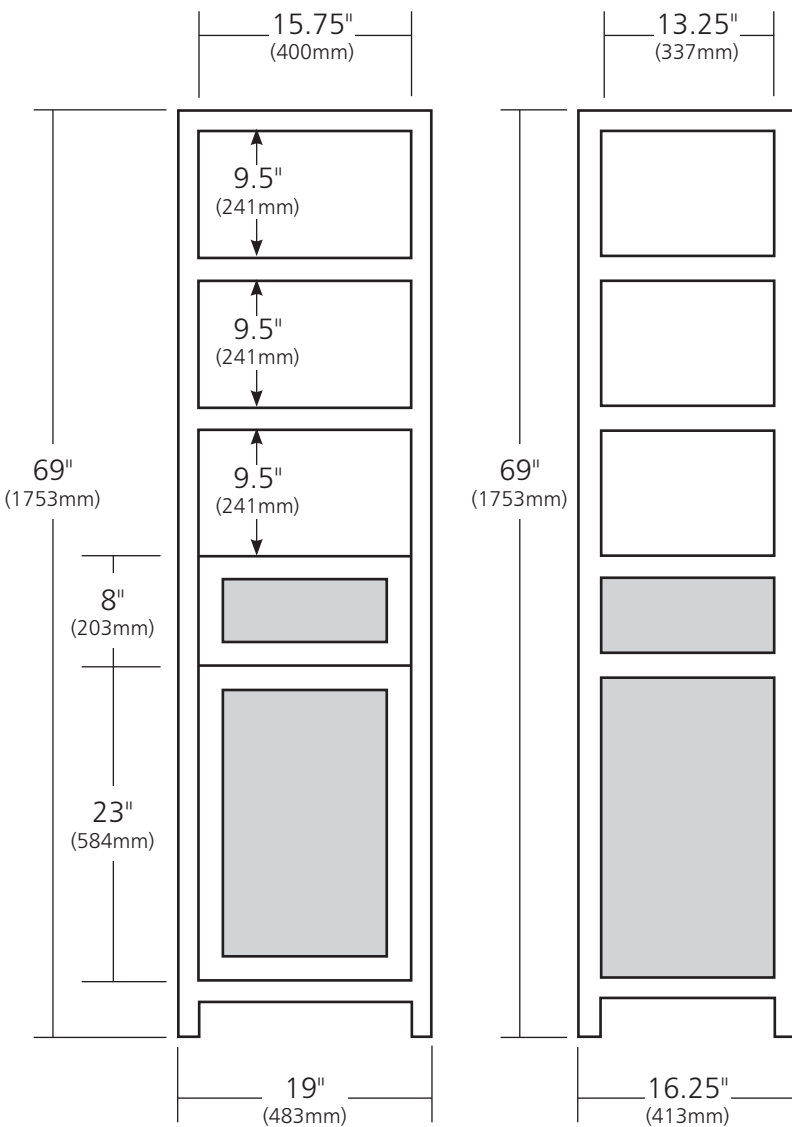

- VNR212 Antique
- VNR215 Brushed Nickel
- VNR216 Carrara

PRODUCT DETAILS

- 19"w x 16.25"d x 69"h (483mm x 413mm x 1753mm)
- Handcrafted, powder-coated steel frame with hand-hammered recycled copper or Carrara marble panels
- Push-to-open drawer
- Push-to-open cabinet door with interior shelf

COORDINATING PRODUCTS

- Cuzco Collection of vanities and mirrors

IMPORTANT

Due to the handcrafted nature of this product, it will vary in finish, texture, and other details. Dimensions may vary up to 1/2" (13mm).