

SPECIFICATIONS

24" CUZCO VANITY

Cuzco Collection

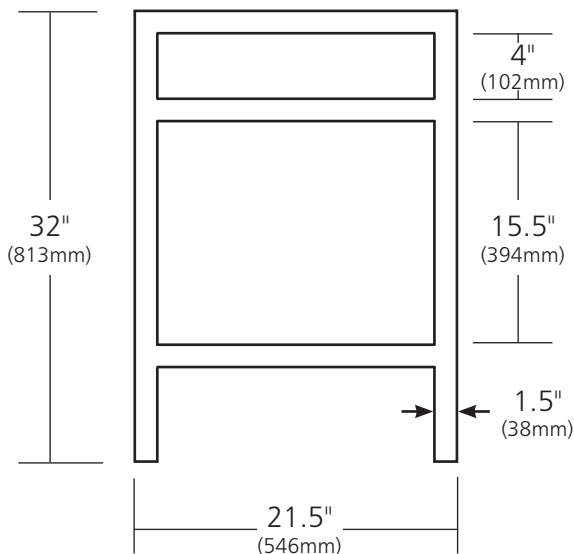
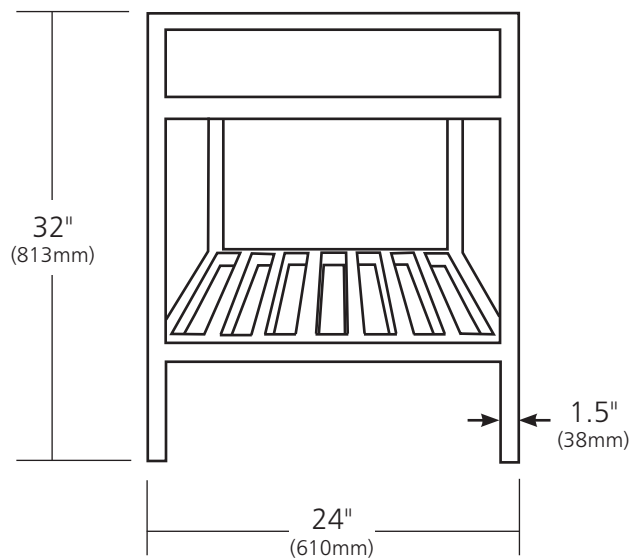

VNR242 Antique
VNR245 Brushed Nickel
VNR246 Carrara

PRODUCT DETAILS

- 24"w x 21.5"d x 32"h (610mm x 546mm x 813mm)
- Handcrafted, powder-coated steel frame with hand-hammered recycled copper or Carrara marble panels

INSTALLATION

- Freestanding vanity base

COORDINATING PRODUCTS

- Any Native Trails stone or quartz vanity top
- Decorative bottle trap
- Havana, Cuzco or Asana Mirror
- Cuzco Linen Tower
- Any Native Trails lavatory sink less than 24" (610mm)

IMPORTANT

Due to the handcrafted nature of this product, it will vary in finish, texture, and other details. Dimensions may vary up to 1/2" (13mm).